

TOWNSHIP 11 N., RANGE 46 E. W. M.
ASOTIN COUNTY, WASHINGTON
& WHITMAN " " "

SCALE 2 IN. = 1 MILE

A- DATED 1933
W- DATED 1934

(66) T. 11 N. R. 46 E.

ASOTIN
& WHITMAN

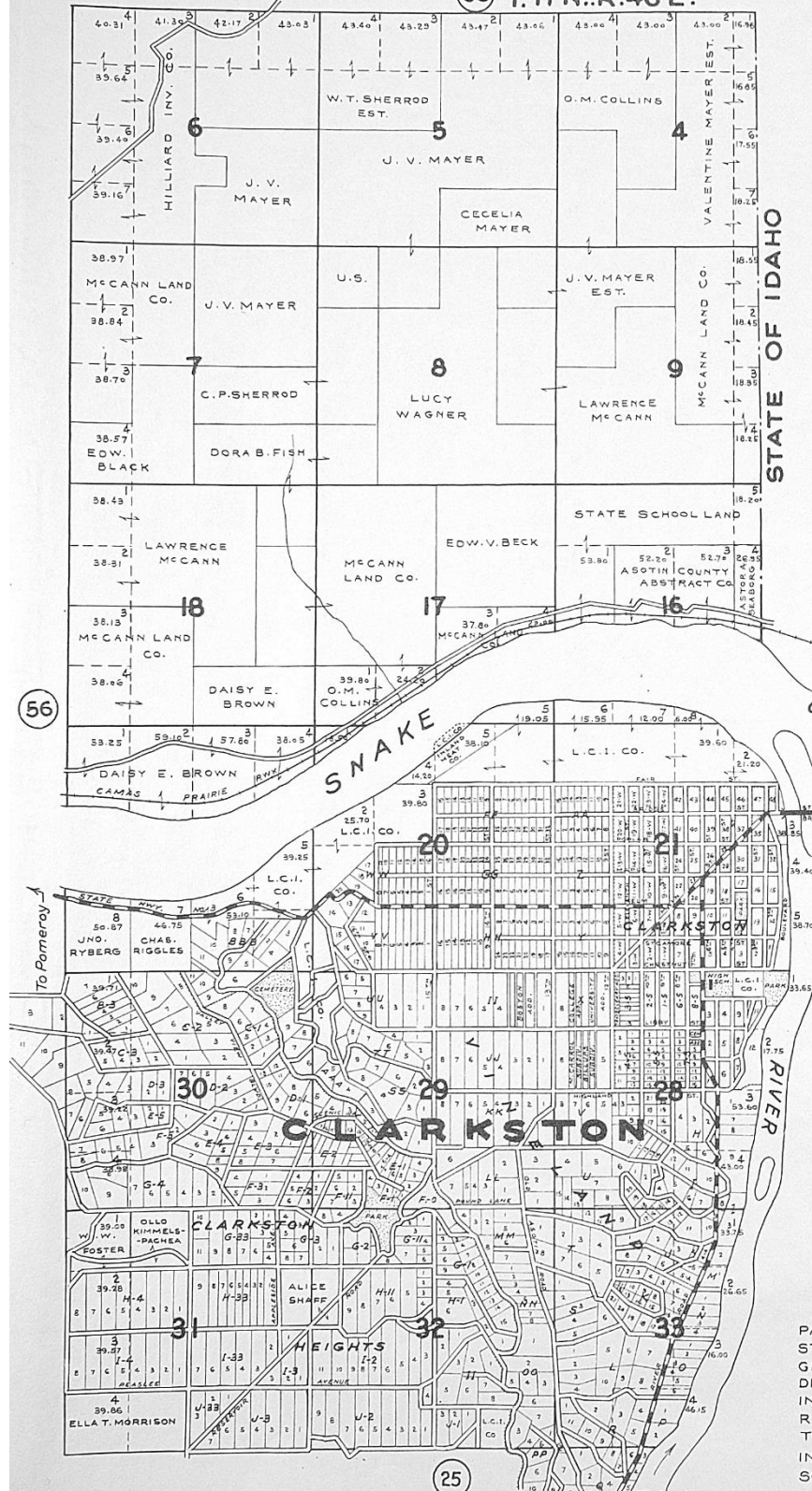

STATE OF IDAHO

PA
ST
GR
DIF
INF
RA
TF
IN
SC